



VGA Extender

User Manual

Model : VE01

Long Range VGA CAT5e Extender 300M



Introduction

VE01 is a VGA extender designed to use a cost-effective 4-pair CAT5 UTP cable to carry the signal, with resolution up to 1600 x 1200@85Hz. getting rid of costly and bulky VGA cable. It's an Ideal solution for classrooms, lecture halls, retail store, PC-training systems, and demo systems for tradeshow.

Features

- Supports up to 1600 x 1200@85Hz.
- Signal extension up to 300M over 4 pairs UTP CAT5e cable.
- Image contrast, brightness adjustable at RX unit.
- Built-in ESD and power protection.

Installation View

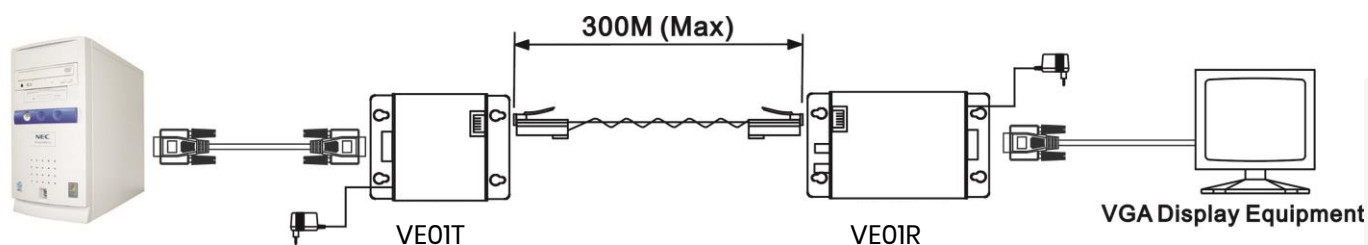

Panel View

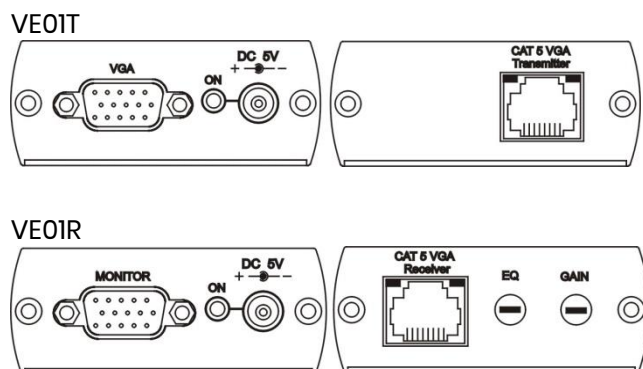

LED Indication

Blue : Power on/off
RJ45 (Link Cable Connector): Green - Signal on/off

Installation Tips

Skew Picture

Due to the inside of CAT5 cable that the pairs of wires are twisted at different rates, and the different quality on cable itself and installation that will cause different signal arrival time at each pair. If there are big different at arrival time, that will cause RGB skew status. This is seen on the monitor as separation, or lack of convergence in colors. Normally it happens on long CAT 5 cable runs.

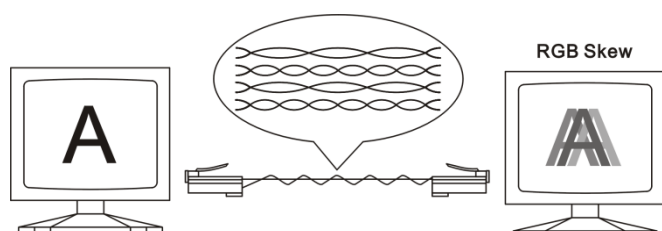

Recommend to use following cabling way to reduce skew status, to add special made "skew immunized adaptor", 2 pieces included at the package.

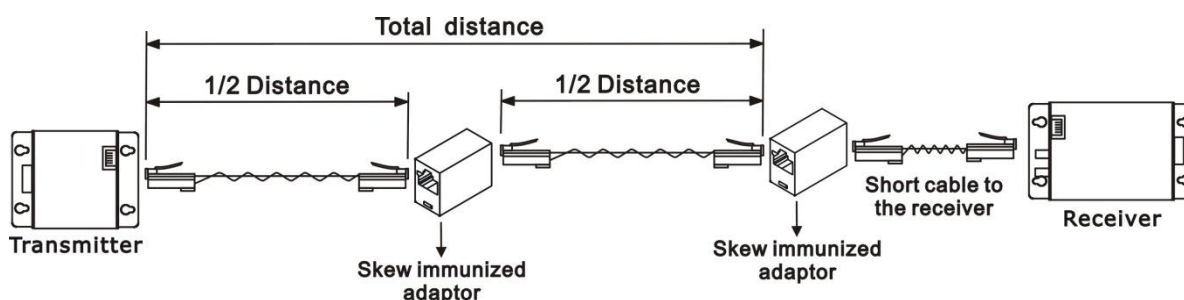

CAUTION

To avoid display equipment damaged, be sure to make correct cable connection and power for both VE01T, VE01R before connecting VE01T, VE01R.

Recommend to change VE01R CAT5 receiver to VE02DALS, which built in RGB skew adjustment for the optimum video performance under long cable run. It also could be daisy chained for another VE02DALS to extended working range over 300 meters and multiple displays.

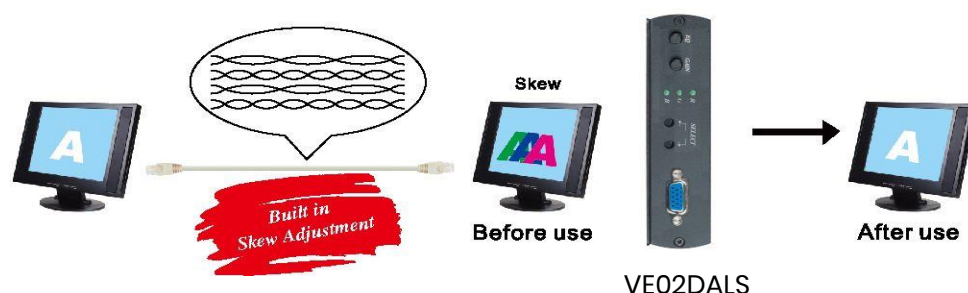

Specification

ITEM NO.	VE01T	VE01R
Support		
Compliance	TTL	
Max. Video Resolution	1600 x 1200@85 Hz	
Max. Transmission Distance	300M	
Video Bandwidth	150MHz	
Frequency	Horizontal at 30 to 95KHz, Vertical at 50 to 180Hz	
Ports & Interfaces		
Video Input	1 x DB15 (75Ω, 0.7Vp-p)	1 x RJ45
Video Output	1 x RJ45	1 x DB15 (75Ω, 0.7Vp-p)
Power		
Power Supply	DC 5V 1A	DC 5V 1A
Power Consumption	150mA (Max)	400mA (Max)
Ambient Temperature		
Operation	0 to 55°C	
Storage	-20 to 85°C	
Humidity	up to 95%	
Physical Characteristics		
Dimensions	67 x 91 x 27mm	67 x 110 x 27mm
Weight	140g	175g